

C 64-217

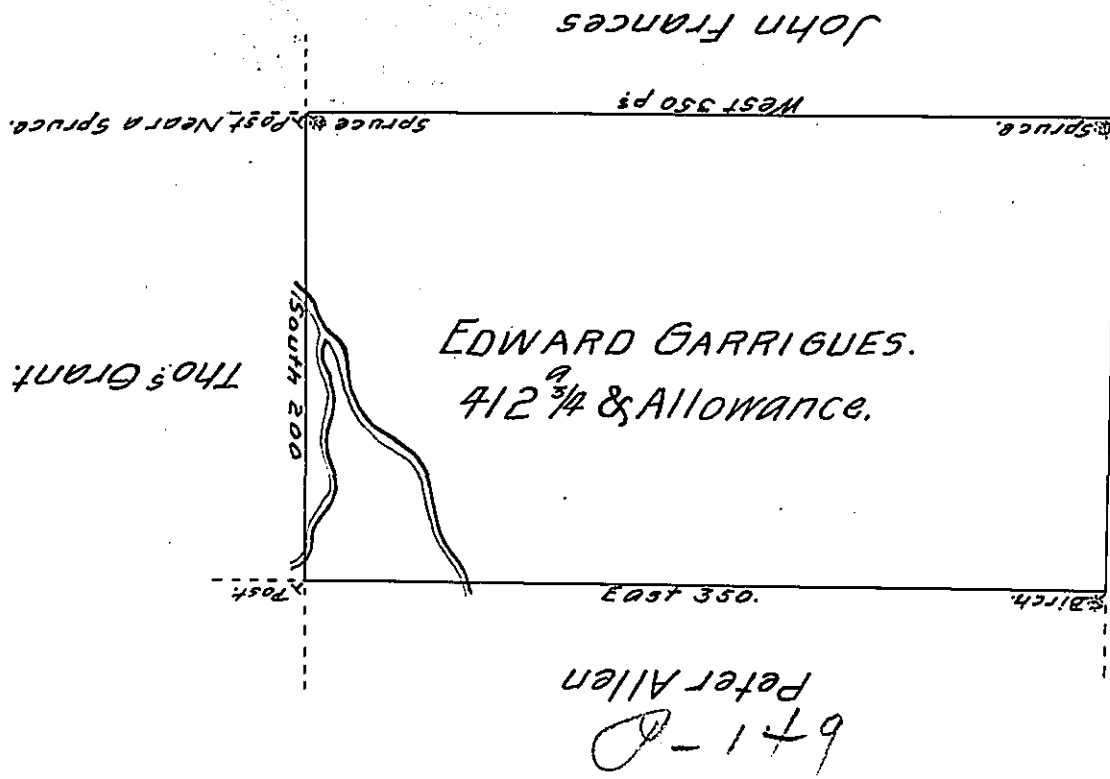

A Draught of a Tract of Land Called ~~_____~~ Situate on the Waters of Snake Creek, Adjoining Land of Peter Allen, and others, in Stoke Township, [±]Northumberland County, Surveyed on the 28th day of Sep^r 1787 for Edward Garrigues by Virtue of his Warrant dated the 27th day of July 1787. Containing four Hundred and Twelve Acres, ³/₄th and allowance of Six p. Cent for Roads &c.

by W^m Gray D. S.

To John Lukens Esq^r }
 Surveyor Gen^l }

± now Luzerne County

IN TESTIMONY that the above is a copy of the original remaining on file in the Department of Internal Affairs of Pennsylvania, made conformably to an Act of Assembly approved the 16th day of February, 1833, I have hereunto set my Hand and caused the Seal of said Department to be affixed at Harrisburg, this eighth day of December 1904.

Isaac P. Brown
 Secretary of Internal Affairs.